

# COUNTY COUNCIL OF BEAUFORT COUNTY

ADMINISTRATION BUILDING  
100 RIBAUT ROAD  
POST OFFICE DRAWER 1228  
BEAUFORT, SOUTH CAROLINA 29901-1228  
TELEPHONE: (843) 255-2180  
FAX: (843) 255-9401  
www.bcgov.net

WM. WESTON J. NEWTON  
CHAIRMAN

D. PAUL SOMMERVILLE  
VICE CHAIRMAN

## COUNCIL MEMBERS

STEVEN M. BAER  
RICK CAPORALE  
GERALD DAWSON  
BRIAN E. FLEWELLING  
HERBERT N. GLAZE  
WILLIAM L. McBRIDE  
STEWART H. RODMAN  
GERALD W. STEWART  
LAURA VON HARTEN

GARY KUBIC  
COUNTY ADMINISTRATOR

BRYAN J. HILL  
DEPUTY COUNTY ADMINISTRATOR

LADSON F. HOWELL  
COUNTY ATTORNEY

SUZANNE M. RAINEY  
CLERK TO COUNCIL

## AGENDA PUBLIC FACILITIES COMMITTEE

Tuesday, August 24, 2010  
4:00 p.m.  
Executive Conference Room  
Administration Building

### Committee Members:

Herbert Glaze, Chairman  
Steven Baer, Vice Chairman  
Gerald Dawson  
Brian Flewelling  
William McBride  
Paul Sommerville  
Jerry Stewart

### Staff Support:

Rob McFee, Division Director

- 4:00 p.m.**
1. CALL TO ORDER
  2. CONSIDERATION OF CONTRACT AWARDS
    - Hilton Head Island Airport Runway 21 On-Airport Tree Obstruction Removal ([backup](#))
    - Storm Debris Removal and Debris Management Site Operation and Disposal Services ([backup](#))
    - Brickman Contract for Landscaping Services for Bluffton and Buckwalter Parkways ([backup](#))
  3. REQUEST FOR QUALIFICATIONS TO PROVIDE ARCHITECTURAL, ENGINEERING AND PLANNING CONSULTING FOR BEAUFORT COUNTY AIRPORT PROJECTS ([backup](#))
  4. RECYCLING AND TRANSFER FACILITY ([backup](#))
  5. ACCEPTANCE OF MATTHEWS DRIVE/BEACH CITY ROAD RIGHT OF WAY ([backup](#))
  6. ADJOURNMENT

County TV Rebroadcast	
Tuesday	1:00 a.m.
Tuesday	10:30 p.m.
Wednesday	1:30 p.m.

Public Facilities		
Date	Time	Location
September 28	4:00 p.m.	ECR
October 26	4:00 p.m.	ECR
November 23	4:00 p.m.	ECR
No Meeting in December		

A quorum of Council may be in attendance at all Committee meetings.  
Please silence your cell phone during the meeting.



County Council of Beaufort County  
Hilton Head Island Airport – [www.hiltonheadairport.com](http://www.hiltonheadairport.com)  
Beaufort County Airport – [www.beaufortcoairport.com](http://www.beaufortcoairport.com)  
120 Beach City Road - Post Office Box 23739  
Hilton Head Island, South Carolina 29925-3739  
Phone: (843) 255-2950 - Fax: (843) 689-5411

TO: Councilman Herbert Glaze, Chairman, Public Facilities Committee

VIA: Gary Kubic, County Administrator *GKubic*  
Bryan Hill, Deputy County Administrator *BHill*  
David Starkey, Chief Financial Officer *DStarkey*  
Rob McFee, Director, Engineering and Infrastructure Division *Rob McFee*

FROM: Paul Andres, Director of Airports *PA*

SUBJ: Hilton Head Island Airport Runway 21 On-Airport Tree Obstruction Removal

DATE: August 17, 2010

**BACKGROUND.** Numerous trees have grown into the 34:1 approach slope on the north end of the Hilton Head Island Airport. These tree obstructions must be removed in order for Beaufort County to remain in compliance with our FAA grant assurances. In response to our Invitation to Bid, the following companies submitted bids to trim or remove the trees:

<u>Name</u>	<u>Location</u>	<u>Base Bid</u>
AllCare Tree Surgery	Bluffton, SC	\$469,948.00
Casey Tree Experts	Lilburn, GA	\$530,800.00
Phillips & Jordan	Robbinsville, NC	\$598,650.00

The base bid amount is to perform the required work exactly as specified in the Town's LMO. Bid Alternative #1 would allow for limited use of mechanized vehicles in the buffer areas. Bid Alternative #2 was for bidder proposed alternative methods. AllCare Tree Surgery was determined to be the lowest responsive and responsible bidder in accordance with the base bid. A review of their bid package revealed that they met all of the bidding requirements to include satisfying FAA DBE goals and local S/MBE outreach. A copy of the Engineer's certification, bid tabulation, and map are attached for your information. The Engineer's estimate for this portion of the work was \$978,915.00. Due to project requirements, this contract is based on both lump sum and unit prices. As such, the final contract price may vary slightly.

**FUNDING.** Funding for this project will come from an FAA Grant (95% pending), State Grant (2.5% pending), and local match (2.5%). The local match of \$11,748.70 will come from the Airports budget under Account Number 13580-59040 which has a current balance of \$88,688.00.

**RECOMMENDATION.** That the Public Facilities Committee approve and recommend to County Council approval of a contract for on-airport tree trimming and removal at the Hilton Head Island Airport to AllCare Tree Surgery, Inc. in the amount of \$469,948.00 contingent upon FAA grant funding.

Attachments: Engineer's Certification, bid tabulation, and map

IFB #2988/110707 - HILTON HEAD ISLAND AIRPORT (HXD) ON-AIRPORT TREE OBSTRUCTION CLEARING RUNWAY 21 APPROACH - BID CHECKLIST

Firm Name:	AllCare Tree Surgery, Inc.	Casey Tree Experts, Inc.	Phillips & Jordan, Inc.
Bidder's Total (Base Bid):	\$469,948.00	\$530,800.00	\$598,650.00
Verified Total:	\$469,948.00	\$530,800.00	\$598,650.00
Bidder's Total (Alternative #1)(Non-Mandatory):	\$416,456.00	\$388,800.00	\$562,650.00
Verified Total:	\$416,446.00	\$388,800.00	\$562,650.00
Bidder's Total (Alternative #2)(Non-Mandatory):	\$391,456.00	No Bid	No Bid
Verified Total:	\$391,446.00	N/A	N/A

Requirement		Y/N	Remarks	Remarks	Y	Remarks
Invitation for Bid (completed & signed)	IFB-1	Y			Y	
Acknowledgement of Addenda	IFB-1	Y			Y	
Bid Bond (stated on Bid Schedule)	IFB-4	Y			Y	
Non-Violation of Federal or State Antitrust Laws	IFB-5	Y			Y	
Local Vendor Preference - Participation Affidavit	IFB-6	Y			N	Not a disqualifier
Non-discrimination Statement	IFB-10	Y			Y	
Proposed Schedule of SMB Participation	IFB-11	Y	4.5% SB; 11.4% MBE	Claims 2.6% SB (Appears to be 5.3%)	Y	4.1% SB
Documentation of Bidder's (S/MB) Recruiting Effort	IFB-12	Y			Y	
S/MB Recruiting Effort Documentation	IFB-14	Y			Y	
Deviations From Terms, Conditions, Provisions, Etc.?	IFB-18	N			N	
References	IFB-20	Y			Y	
DBE Goal - 2.6%	IFB-3	Y	11.4% DBE	Could not determine	N	Could not determine
Attended Non-Mandatory Pre-Bid Meeting (08 JUL 2010)	IFB-2	Y		Non-mandatory	N	Non-mandatory
Bid on Base Bid (Mandatory)	IFB-4 & 5	Y			Y	
Bid on Alternative #1 (Non-mandatory)	IFB-4 & 5	Y			Y	
Bid on Alternative #2 (Non-mandatory)	IFB-4 & 5	Y		Non-mandatory	N	Non-mandatory
Copy of (S/MB) Certification Certificates	IFB-22	Y		Not a disqualifier if certification is confirmed	N	Not a disqualifier if certification is confirmed

**Summary of Bid Reviews**

In consultation with the Town of HHI, Beaufort County decided not to pursue Alternative #2 because it does not comply with the LMO.

In consultation with the Town of HHI, Beaufort County decided not to pursue Alternative #3 bid by AllCare Tree Surgery, Inc. because it does not comply with the LMO.

AllCare Tree Surgery, Inc. submitted the lowest responsive Base Bid.

No bids were considered to be non-responsive, although supplemental information and clarification would have been needed from Casey Tree Experts and/or Phillips & Jordan if either had submitted the lowest bid.

**Prepared By:**

*Charles F. Steams* 08/13/2010  
Charles F. Steams, PE, Wilbur Smith Associates

**PROPOSED SCHEDULE OF S/MB PARTICIPATION (Sec 2.537.2.2)**

Name of Bidder/Proposer: AllCare Tree Surgery Inc.

Bid No: IFB# 2988/110707

Project Title: on-Airport tree obstruction removal

Total Bid Amount: Base Bid \$ 469,948

Name of Participant	Address	Type of Work Subcontracted	Subcontract Value	SB or MB Status
Cherry Consulting of the Carolinas, Inc	6227 Guthrie Court Charlotte, NC 28210	• Risk Management • Safety Development & Training • Surveying & Field Safety Engineer	53,475	SB / MB
Tim's Crane & Rigging (912) 748-1318	117 Sharon Court Pooler GA 31322	• Crane Service	6,000	non-registered small business local
Coastal debris (843) 645-9898	161 Whispering Pines Ln Ridgeland 29936	• Handling • Debris Recycling	7,500	non-registered small business local
JS Construction (843) 645-3900	PO Box 1497 Bluffton SC 29910	• Handling • Debris Recycling	7,500	non-registered small business local

Non Registered Local Small Business Value: 4.5 % \$ 21,000

Small Business Participation Value: 0 % \$ 0

Minority Participation Value: 11.4 % \$ 53,475

The undersigned will enter into a formal agreement with the S/MB Subcontractors/Proposers identified herein for work listed in this schedule conditioned upon executing of a contract with Beaufort County Council.

Signature: 

Title: General Manager

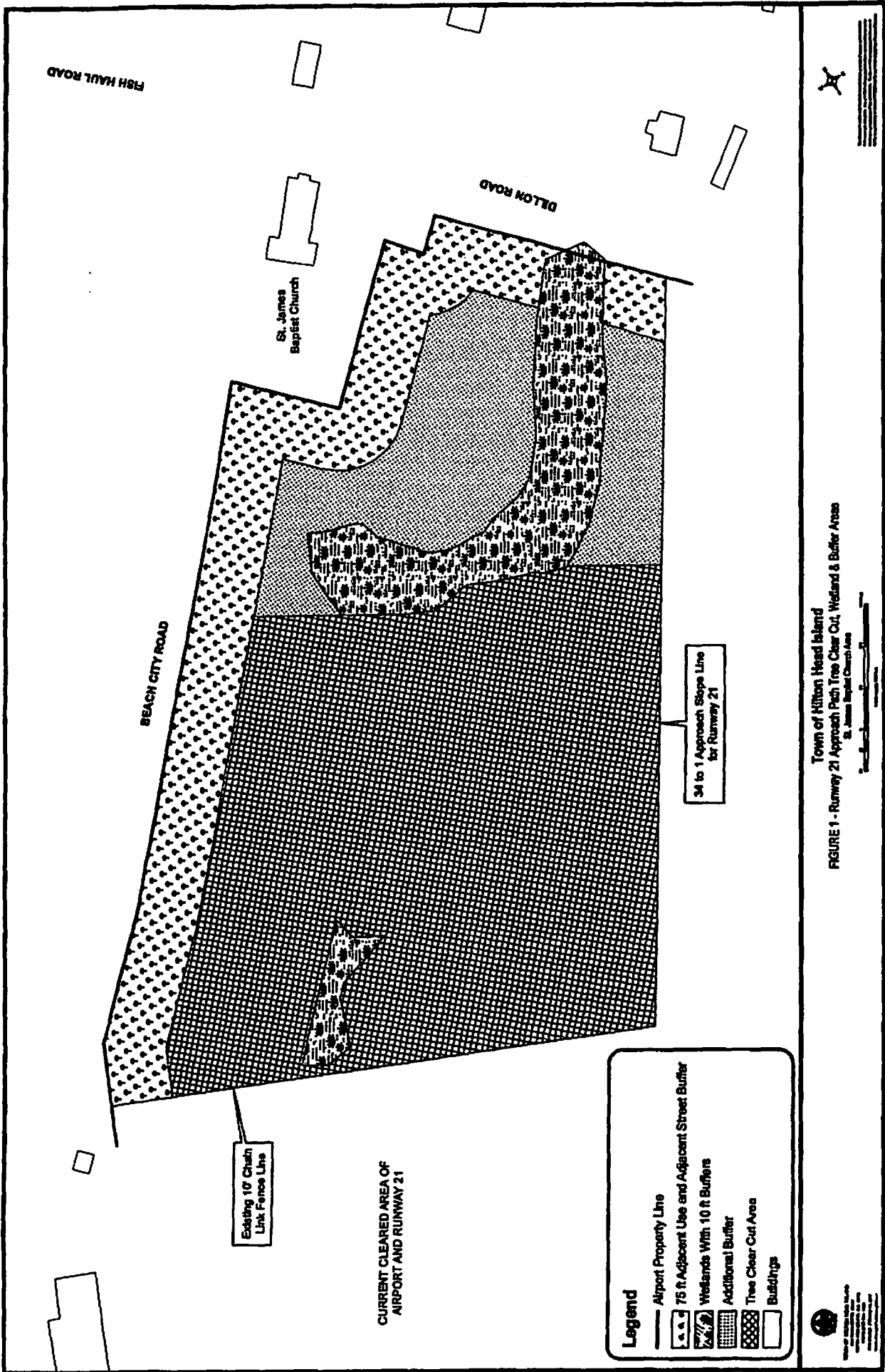

IFB #2988/110707 - HILTON HEAD ISLAND AIRPORT (HXD) ON-AIRPORT TREE OBSTRUCTION CLEARING RUNWAY 21 APPROACH - BID TABULATION

Certified Bid Tabulation

BASE BID			Bidder →		All Care Tree Surgery		Casey Tree Experts		Phillips & Jordan, Inc.	
Item #	Specification	Description	Unit	Est Qty	Unit Cost	Extended Total	Unit Cost	Extended Total	Unit Cost	Extended Total
1	S-101	Mobilization	LS	1	\$5,000.00	\$5,000.00	\$10,000.00	\$10,000.00	\$28,000.00	\$28,000.00
2	S-102-4.1	Clearing of Trees in Non-Wetland, Non-Buffer Areas	LS	1	\$142,345.00	\$142,345.00	\$145,000.00	\$145,000.00	\$108,000.00	\$108,000.00
3	S-102-4.2	Clearing/Trimming of Trees <6" DBH within Wetlands and Buffer	LS	1	\$15,000.00	\$15,000.00	\$10,000.00	\$10,000.00	\$55,000.00	\$55,000.00
4	S-102-4.3	Removal of Pine Tree 6" or Greater DBH within Wetlands and Buffer	EA	32	\$671.00	\$21,472.00	\$500.00	\$16,000.00	\$450.00	\$14,400.00
5	S-102-4.4	Removal of Hardwood Tree 6" to 12" DBH within Wetlands and Buffer	EA	194	\$379.00	\$73,526.00	\$600.00	\$116,400.00	\$775.00	\$150,350.00
6	S-102-4.5	Removal of Hardwood Tree 13" to 24" DBH within Wetlands and Buffer	EA	88	\$631.00	\$55,528.00	\$800.00	\$70,400.00	\$950.00	\$83,600.00
7	S-102-4.6	Removal of Hardwood Tree Greater Than 24" DBH within Wetlands and Buffer	EA	34	\$1,199.00	\$40,766.00	\$1,200.00	\$40,800.00	\$1,350.00	\$45,900.00
8	S-102-4.7	Trimming of Hardwood Tree by 1 to 10 Feet within Wetlands and Buffer	EA	78	\$410.00	\$31,980.00	\$600.00	\$46,800.00	\$500.00	\$39,000.00
9	S-102-4.8	Trimming of Hardwood Tree by 11 to 20 Feet within Wetlands and Buffer	EA	56	\$551.00	\$30,856.00	\$900.00	\$50,400.00	\$650.00	\$36,400.00
10	S-103-3.1	Surveying	LS	1	\$53,475.00	\$53,475.00	\$25,000.00	\$25,000.00	\$38,000.00	\$38,000.00
					Total	\$469,948.00	Total	\$530,800.00	Total	\$598,650.00

ALTERNATIVE #1 (Addendum #1, Limited Access to Buffer Areas by Mechanized Vehicles)

Item #	Specification	Description	Unit	Est Qty	Unit Cost	Extended Total	Unit Cost	Extended Total	Unit Cost	Extended Total
1	S-101	Mobilization	LS	1	\$5,000.00	\$5,000.00	\$10,000.00	\$10,000.00	\$28,000.00	\$28,000.00
2	S-102-4.1	Clearing of Trees in Non-Wetland, Non-Buffer Areas	LS	1	\$142,345.00	\$142,345.00	\$145,000.00	\$145,000.00	\$72,000.00	\$72,000.00
3	S-102-4.2	Clearing/Trimming of Trees <6" DBH within Wetlands and Buffer	LS	1	\$15,000.00	\$15,000.00	\$5,000.00	\$5,000.00	\$55,000.00	\$55,000.00
4	S-102-4.3	Removal of Pine Tree 6" or Greater DBH within Wetlands and Buffer	EA	32	\$560.00	\$17,920.00	\$300.00	\$9,600.00	\$450.00	\$14,400.00
5	S-102-4.4	Removal of Hardwood Tree 6" to 12" DBH within Wetlands and Buffer	EA	194	\$268.00	\$51,992.00	\$300.00	\$58,200.00	\$775.00	\$150,350.00
6	S-102-4.5	Removal of Hardwood Tree 13" to 24" DBH within Wetlands and Buffer	EA	88	\$520.00	\$45,760.00	\$500.00	\$44,000.00	\$950.00	\$83,600.00
7	S-102-4.6	Removal of Hardwood Tree Greater Than 24" DBH within Wetlands and Buffer	EA	34	\$1,088.00	\$36,992.00	\$800.00	\$27,200.00	\$1,350.00	\$45,900.00
8	S-102-4.7	Trimming of Hardwood Tree by 1 to 10 Feet within Wetlands and Buffer	EA	78	\$299.00	\$23,322.00	\$400.00	\$31,200.00	\$500.00	\$39,000.00
9	S-102-4.8	Trimming of Hardwood Tree by 11 to 20 Feet within Wetlands and Buffer	EA	56	\$440.00	\$24,640.00	\$600.00	\$33,600.00	\$650.00	\$36,400.00
10	S-103-3.1	Surveying	LS	1	\$53,475.00	\$53,475.00	\$25,000.00	\$25,000.00	\$38,000.00	\$38,000.00
					Total	\$416,446.00	Total	\$388,800.00	Total	\$562,650.00

ALTERNATIVE #2 (Addendum #1, Bidder Proposed Alternative)

Item #	Specification	Description	Unit	Est Qty	Unit Cost	Extended Total	Unit Cost	Extended Total	Unit Cost	Extended Total
1	S-101	Mobilization	LS	1	\$5,000.00	\$5,000.00				
2	S-102-4.1	Clearing of Trees in Non-Wetland, Non-Buffer Areas	LS	1	\$117,345.00	\$117,345.00				
3	S-102-4.2	Clearing/Trimming of Trees <6" DBH within Wetlands and Buffer	LS	1	\$15,000.00	\$15,000.00				
4	S-102-4.3	Removal of Pine Tree 6" or Greater DBH within Wetlands and Buffer	EA	32	\$560.00	\$17,920.00				
5	S-102-4.4	Removal of Hardwood Tree 6" to 12" DBH within Wetlands and Buffer	EA	194	\$268.00	\$51,992.00				
6	S-102-4.5	Removal of Hardwood Tree 13" to 24" DBH within Wetlands and Buffer	EA	88	\$520.00	\$45,760.00				
7	S-102-4.6	Removal of Hardwood Tree Greater Than 24" DBH within Wetlands and Buffer	EA	34	\$1,088.00	\$36,992.00				
8	S-102-4.7	Trimming of Hardwood Tree by 1 to 10 Feet within Wetlands and Buffer	EA	78	\$299.00	\$23,322.00				
9	S-102-4.8	Trimming of Hardwood Tree by 11 to 20 Feet within Wetlands and Buffer	EA	56	\$440.00	\$24,640.00				
10	S-103-3.1	Surveying	LS	1	\$53,475.00	\$53,475.00				
					Total	\$391,446.00	Total		Total	

Prepared By:

*Charles F. Stearns* 08/13/2010  
 Charles F. Stearns, PE, Wilbur Smith Associates



**BEAUFORT COUNTY PUBLIC WORKS**  
 120 Shanklin Road  
 Beaufort, South Carolina 29906  
 Phone (843) 255-2800



**TO:** Councilman Herbert N. Glaze, Chairman, Public Facilities Committee

**VIA:** Gary Kubic, County Administrator *GKubic*  
 Robert McFee, Division Director, Engineering and Infrastructure *RR McFee*  
 Eddie Bellamy, Public Works Director *ECB 8/3*

**FROM:** James S. Minor, Jr., Solid Waste Manager *JSM*

**SUBJ:** RFP # 3990/100461: STORM DEBRIS REMOVAL & DEBRIS MANAGEMENT SITE OPERATION & DISPOSAL SERVICES

**DATE:** July 29, 2010

**BACKGROUND.** Beaufort County issued a Request for Proposals (RFP) to solicit proposals from qualified firms to provide disaster debris removal, reduction, disposal and other emergency cleanup services following a debris-generating event, such as a tropical system or other natural and man-made disasters. Responses were received from fourteen firms which were evaluated with the help of our debris monitoring firm, Beek Disaster Recovery, Inc., which compiled the bid tables into spreadsheets to facilitate analysis using a Category 1 storm as a basis. A Category 1 storm has the potential to generate a large amount of vegetative debris while limiting the amount of other debris and is very likely scenario. The list was narrowed to four firms which were invited to meet and make presentations to the panel. The following firms met with the panel on June 4, 2010: (1) CERES Environmental (CERES) (2) DRC, Emergency Services (DRC) LLC. (3) Storm Reconstructive Services, Inc.; (4) Unified Recovery Group, Inc.

A review panel consisting of the Division Director, Engineering and Infrastructure, the Public Works Director, the Solid Waste Manager, Solid Waste Information Coordinator/Data Analyst, and the Assistant Director of the Emergency Management Department, evaluated the firm's proposals, presentations and responses to their questions. The panel ranked the firm's according to the RFP selection criteria. Negotiations with the highest ranked firm were successful and we have reached an agreement with DRC to perform as our primary debris removal contractor. Negotiations with the second ranked firm, CERES to perform as our secondary debris removal contractor were also successful and an agreement was reached. The agreement with both firm's are for an initial two year contract with three one-year renewal options.

**RECOMMENDATION.**

(1) Recommend that the Public Services Committee approve and recommend to Council award of the primary contract for disaster debris removal, reduction, disposal and other emergency cleanup services to DRC Emergency Services, LLC.

(2) Recommend that the Public Services Committee approve and recommend to Council award of the secondary contract for disaster debris removal, reduction, disposal and other emergency cleanup services to CERES Environmental Inc.

Cc: Dave Thomas, Purchasing Director  
 Richard Hinline, Contract Specialist  
 JSM/jsm



**RFP #3990/100461**  
**Storm Debris Removal Debris Management Site Operation and Disposal Services**  
**Bid Analysis**

Schedule 2 - Unit Rate Price Schedule	Ashbritt, Inc.	Asplundh, Inc.	Bergeron Emergency	Ceres Environmental	Crowder Gulf	DRC Emergency
Cradle to Grave (Cubic Yards)	\$24,862,500	\$19,442,188	\$23,793,750	\$26,067,313	\$16,447,500	\$13,971,535
	DTS, Inc.	JB Coxwell Contracting, LLC	Ommi Pinnaelo, LLC	Phillips and Jordan, Inc	SRS, Inc.	Tag Grinding Services, Inc
Cradle to Grave (Cubic Yards)	\$24,463,125	To be negotiated	\$16,059,375	No Bid	\$14,203,563	\$14,146,250
	TFR Enterprises	Unified Recovery				
Cradle to Grave (Cubic Yards)	\$19,065,750	\$13,531,250				





**COUNTY COUNCIL OF BEAUFORT COUNTY  
PURCHASING DEPARTMENT**

Building 2, 102 Industrial Village Road  
Post Office Drawer 1228, Beaufort, SC 29901-1228  
Phone: (843) 255-2353 Fax: (843) 470-2738

TO: Councilman Herbert N. Glaze, Chairman, Public Facilities Committee

VIA: Gary Kubic, County Administrator *GKubic*  
Bryan Hill, Deputy County Administrator *BHill*  
David Starkey, Chief Financial Officer *DStarkey*  
Robert McFee, Director of Engineering and Infrastructure  
Eddie Bellamy, Director of Public Works

FROM: Dave Thomas, CPPO, Purchasing Director *DT*

SUBJ: Contract Renewal for Landscaping Services for Beaufort Public Works Department

DATE: August 18, 2010

**BACKGROUND:** A Request for Proposal (RFP) was advertised last year (April 2009) requesting proposals from qualified landscaping service providers. A one year contract with four one year renewals was awarded to the Brickman Group and covers landscaping services along the Bluffton Parkway (7.73 miles) from the traffic circle at the intersection with Rt. 46 west to Rt. 170, and the Buckwalter Parkway (4.37 miles) from the intersection with Rt. 278 South to May River Road. Examples of work are: mowing and trimming turf areas in medians and between the roadway and adjacent pathway, and between the pathway and the drainage ditch, mulching around trees and shrubs planted in medians, fertilizing, seeding, and litter removal in areas covered by the contract.

**Contract Cost:** Last year \$147,837.00 which included a onetime replacement cost for dead trees and shrubs (6,837.00). Annual cost for the contract renewal will be \$141,000.00. (\$11,750.00 per month)

**Fund:** 100-33042-51110 Maintenance Contracts

**Recommendation:** The Public Facilities Committee approve and recommend to County Council the contract renewal for Landscaping Services to Brickman for an annual contract amount of \$141,000.00 with three additional one year contract renewal periods with annual costs of \$141, 000.00, all subject to the approval of Beaufort County Council.

Cc: Richard Hinline



## COUNTY COUNCIL OF BEAUFORT COUNTY PURCHASING DEPARTMENT

Building 2, 102 Industrial Village Road  
Post Office Drawer 1228, Beaufort, SC 29901-1228  
Phone: (843) 255-2353 Fax: (843) 470-2738

TO: Councilman Herbert N. Glaze, Chairman, Public Facilities Committee

VIA: Gary Kubic, County Administrator  
Bryan Hill, Deputy County Administrator  
Robert McFee, Director of Engineering and Infrastructure  
Paul Andres, Director of Airports

PA

FROM: Dave Thomas, CPPO, Purchasing Director

**SUBJ: RFQ # 3905/100670 Request for Qualifications to provide "Architectural, Engineering, and Planning Consulting for Beaufort County Airport Projects"**

**DATE:** August 9, 2010

**BACKGROUND:** Beaufort County issued a Request for Qualifications (RFQ) to firms capable of providing professional architectural, engineering, and planning consulting services for Beaufort County Airport projects. The intent of the RFQ was to prequalify two Aviation consulting firms to provide professional consulting services for future Airport projects. The typical scope of services will require the consultants to oversee, design, develop and manage the various airport projects to be negotiated separately. The initial term for these prequalification contracts will be for one year, with four additional one year renewal options. The evaluation committee consisted of five (5) members: Pete Buchanan, Chairman Airport Board, Will Dopp, Airport's Board member, Rob McFee, Director of Engineering and Infrastructure, Bob Klink, Beaufort County Engineer, and Paul Andres, Director of Airports. Beaufort County received nine (9) responses to the RFQ. The evaluation committee reviewed and evaluated all responses and selected the following four (4) firms for interviews: LPA, Talbert & Bright, PBS & J, WK Dickson.

After the interviews and based on the RFQ evaluation criteria and professional experience, Talbert & Bright and LPA were selected as the top two firms to provide professional consulting services for Beaufort County Airport projects. Both firms will meet or exceed the FAA required DBE goals for each project.

### FINAL EVALUATION RANKING:

- 1 Talbert & Bright, Charlotte, NC-(local subs, J.K. Tiller Asso., Landscape Planning, Bluffton,, Allcare Tree Surgery, HHI, Chris Gerards, Arborist, Bluffton)
- 2 LPA, Columbia, SC, (local subs, J.K. Tiller Asso., Landscape Planning, Bluffton, Andrews & Burgess, Architectural Survey, Beaufort, BES Incorporated, Mechanical, Elec, Plumbing, Beaufort)
- 3 WK Dickson, Columbia, SC
- 4 PBS & J, Atlanta, GA
- 5 Campbell & Paris, Chantilly, VA
- 6 URS, Savannah, GA
- 7 Avcon, Charlotte, NC
- 8 Dennis Corp, Columbia, SC

**FUNDING:** Primarily from FAA Grant Funding.

**RECOMMENDATION:** The Public Facilities Committee approve and recommend to County Council approval of Talbert & Bright and LPA to provide Professional Aviation Consulting Services on an as needed basis. The evaluation committee further recommends to the Public Facilities Committee and County Council that County staff be authorized to negotiate individual contracts with either firm depending on the type of Airport project and the availability of the firms to meet the County's schedule and budget. Each contract will be subject to approval by the appropriate Council Committee or full Council.



**BEAUFORT COUNTY PUBLIC WORKS**  
 120 Shanklin Road  
 Beaufort, South Carolina 29906  
 Voice (843) 470-6400 Facsimile (843) 470-6418



**TO:** Councilman Herbert N. Glaze, Chairman, Public Facilities Committee

**VIA:** Gary Kubic, County Administrator *G Kubic*  
 Robert McFee, Division Director, Engineering and Infrastructure *J R McFee*  
 Eddie Bellamy, Public Works Director *UCB 9/3*

**FROM:** Solid Waste and Recycling Advisory Board

**SUBJ:** Recycling and Transfer Facility (RTF) Recommendation

**DATE:** July 29, 2010

**BACKGROUND.** Beaufort County has no alternative for the disposal of Municipal Solid Waste (MSW) other than the Hickory Hill landfill located in Jasper County which is owned and operated by Waste Management, Inc. The County has no control over what may or may not happen at Hickory Hill. The current contract with Waste Management to dispose of waste at Hickory Hill expires June 30, 2015. According to the Annual Report issued by SCDHEC, Hickory Hill has 13 years of remaining life at its current rate of use. To transport MSW to another landfill in a cost effective manner, requires a solid waste transfer station at which waste is transferred into larger trucks to be hauled the greater distance. In addition, the County has no facility at which to process, recycle and/or dispose of the various special waste streams such as electronics, household hazardous waste, and white goods. We feel it is in the best interest of the County to develop such a facility to handle the current and future waste streams within Beaufort County. An RTF would provide:

- a. The option to transport our waste to more distant landfills in a cost effective manner.
- b. The option to process our own recyclables for market.
- c. The required facility to handle "special waste" (household hazardous, electronics, white goods)
- d. An improved bargaining position for future disposal costs.

Technology or disposal alternatives down the road may change but for the foreseeable future hauling to landfills or some other disposal facility for waste streams of the volume of ours, an RTF is the most viable option. Many of the waste to energy technologies are only realistic for large volumes at the present time. Counties are charged by SC state law with the responsibility to plan and provide for waste disposal. An RTF may have a positive effect for the Beaufort County municipalities which contract for waste hauling by shortening travel time for their contractor's and reducing maintenance costs, which may reflect in lower contract costs for the municipalities. An RTF provides a vital link in our solid waste management system which will provide a facility with the flexibility to meet the demands of the waste stream of the future.

**RECOMMENDATION.**

We recommend that the Public Facilities Committee support the recommendation of the Solid Waste Advisory Board and recommend to County Council that Beaufort County pursue in a timely manner the purchase of suitable property(s) and the construction of one or more RTF(s) to create waste disposal alternatives for the future and provide the facility(s) needed to process special wastes generated within Beaufort County.



MEMBER  
 NATIONAL SAFETY COUNCIL





**COUNTY COUNCIL OF BEAUFORT COUNTY  
BEAUFORT COUNTY ENGINEERING DIVISION**

**102 Industrial Village Road, Building #3, 29906  
Post Office Drawer 1228, Beaufort, SC 29901-1228  
Telephone: 843-255-2692 Facsimile: 843-255-9420**

TO: Councilman Herbert Glaze, Chairman, Public Facilities Committee

VIA: Gary Kubic, County Administrator *GKubic*  
Bryan Hill, Assistant County Administrator *BHill*  
Robert McFee, Director, Engineering and Infrastructure *RMcFee*

FROM: Robert Klink, County Engineer *RKlink*

SUBJ: **Acceptance of Matthews Drive/Beach City Road Right-of-Way**

DATE: August 18, 2010

**Background.** At the 6/29/10 Public Facilities Committee meeting the above referenced subject was discussed with the Committee, County staff, and Town of Hilton Head staff. The Committee requested that the new right-of-way to be transferred to the County be kept at a minimum. Town of Hilton Head staff met with SCDOT and have indicated on the attached 8/17/10 correspondence where the new limits of the SCDOT and County right-of-way would be; which would result in a net 5,000 square yards of new right-of-way for the County. The Town of Hilton Head will be constructing the new roundabout at no expense to the County.

**Recommendation.** As the roundabout is expected to bring benefits in terms of traffic calming and safety, it is recommended that the Public Facilities Committee approve and recommend to County Council the acceptance of the SCDOT right-of-way for Beach City Road/Matthews Drive Roundabout.

REK/mjh

Attachments: 1) 8/17/10 Town of Hilton Head Correspondence  
2) 6/21/10 Public Facilities Committee Items

cc: Eddie Bellamy

z/PSC/11-01 matthews dr-beach city road row #2

# TOWN OF HILTON HEAD ISLAND

One Town Center Court, Hilton Head Island, S.C. 29928

(843) 341-4600 Fax (843) 842-7728

[www.hiltonheadislandsc.gov](http://www.hiltonheadislandsc.gov)

August 17, 2010

Thomas D. Peeples  
Mayor

Kenneth S. Heltzke  
Mayor Pro Tem

\_\_\_\_\_  
Council Members

Willie (Bill) Ferguson  
William D. Harkins  
Drew A. Laughlin  
John Safay  
George W. Williams, Jr.

\_\_\_\_\_  
Stephen G. Riley  
Town Manager

Mr. Robert McFee, P.E.  
Director of Engineering & Infrastructure Division  
Beaufort County  
P.O. Drawer 1228  
Beaufort, SC 29901

Re: Mathews Drive (S-44) North Pathway and  
Roundabout Project at Beach City Road (S-333)

Dear Rob:

I am writing in response to the actions taken at the County Public Facilities meeting held on June 29<sup>th</sup> regarding ownership of the referenced project. The Town met with SCDOT staff on July 14<sup>th</sup> to determine the SCDOT's minimum roadway abandonment for encroachment permit approval of the project. Based upon that meeting, SCDOT staff stated that they would adjust the future state limits to maintain approximately 85 linear feet more of Beach City Road and approximately 116 LF more of Mathews Drive than they originally offered. These adjusted limits are shown in the attached figure. They will not accept ownership of the future roundabout.

The SCDOT staff also stated they would issue the encroachment permit for construction of the project once the Town or County representatives sign the updated right-of-way abandonment form. The full abandonment of the roadway would require State Highway Commission approval.

The Town is also prepared to include a five-year extended warranty as a bid alternate on the roadway improvement construction bid package. I would recommend that Town and County Staffs review the pricing for this alternate to determine a final course of action regarding the provision of a five-year warranty.

The Town proposes to maintain the landscaping, multi-use pathway, and storm drainage infrastructure within the roundabout right of way just as we do in other County rights of way on the island, however I request that the County adopt this portion of road and right of way. The County's adoption of this right of way will avoid the creation of a noncontiguous, island of right way between two other owners: the County and State. These improvements will provide much needed safety enhancements to this intersection, benefiting motorists with such destinations as the Hilton Head Airport and Barker Field. We appreciate very much your consideration of this request. Please do not hesitate to contact me at 843-341-4776 or [scottl@hiltonheadsc.gov](mailto:scottl@hiltonheadsc.gov) if you have any questions.

Best regards,

  
Scott Liggett, P.E.  
Director of Public Projects and Facilities

---

# **TOWN OF HILTON HEAD ISLAND**

One Town Center Court, Hilton Head Island, S.C. 29928

(843) 341-4600 Fax (843) 842-7728

[www.hiltonheadislandsc.gov](http://www.hiltonheadislandsc.gov)

**Thomas D. Peoples**  
Mayor

**Kenneth S. Heitzke**  
Mayor ProTem

---

**Council Members**

**Willie (Bill) Ferguson**  
**William D. Harkins**  
**Drew A. Laughlin**  
**John Safay**  
**George W. Williams, Jr.**

---

**Stephen G. Riley**  
Town Manager

**Attachment – Figure of State Ownership**

cc: **Jennifer Lyle, Town of Hilton Head Island**  
**Jeff Buckalew, Town of Hilton Head Island**  
**Robert Clark, SCDOT District 6 Engineering Administrator**

NO.	DATE	BY	REVISION
1	11/11/11	SCD	ISSUE FOR CONSTRUCTION

**CURVE #282**  
 P.I. = 282+22.41  
 X = 2,076,482.4767  
 Y = 142,806.4118  
 A = 137° 49' 52" CRT  
 D = 137° 52' 37"  
 T = 73.87'  
 L = 148.82'  
 E = 6.80'  
 R = 445.88'  
 O = MC  
 P.C. = 284+16.74  
 P.T. = 289+74.76

**CURVE #281**  
 P.I. = 282+00.00  
 X = 2,076,381.4574  
 Y = 141,068.8263  
 A = 257° 59' 29" CRT  
 D = 127° 19' 25"  
 T = 0.00'  
 L = 789.74'  
 E = 16.80'  
 R = 45.88'  
 O = MC  
 P.C. = 282+00.00  
 P.T. = 282+82.74

**CURVE #283**  
 P.I. = 282+21.77  
 X = 2,076,295.4253  
 Y = 141,841.8013  
 A = 127° 23' 50" CRT  
 D = 137° 29' 42"  
 T = 38.52'  
 L = 78.79'  
 E = 2.26'  
 R = 327.58'  
 O = MC  
 P.C. = 281+03.24  
 P.T. = 282+69.74

**CONSTRUCT SCOT**  
 TYPE 2 CURVE  
 STA. 800+00.00 TO 800+17.00

**CONSTRUCT SCOT**  
 TYPE 2 CURVE  
 STA. 800+00.00 TO 800+17.00

**(44)**  
 RS10-004-000-0304-0000  
 N/T  
 CAR. INCOME PALMETTO LLC

**END VERTICAL FACE**  
 CURB AND GUTTER  
 STA. 800+17.00

**END 2-D VERTICAL FACE**  
 CURB AND GUTTER  
 STA. 800+17.00

**PRES. COUNTY R/W**  
 FORMERLY S-07-333  
 SEE SCOT FILE 7.345

**PRES. COUNTY R/W**  
 FORMERLY S-07-333  
 SEE SCOT FILE 7.345

**PRES. COUNTY R/W**  
 FORMERLY S-07-333  
 SEE SCOT FILE 7.345

**END CONSTRUCTION**  
 BEACH CITY ROAD  
 STA. 800+04.54

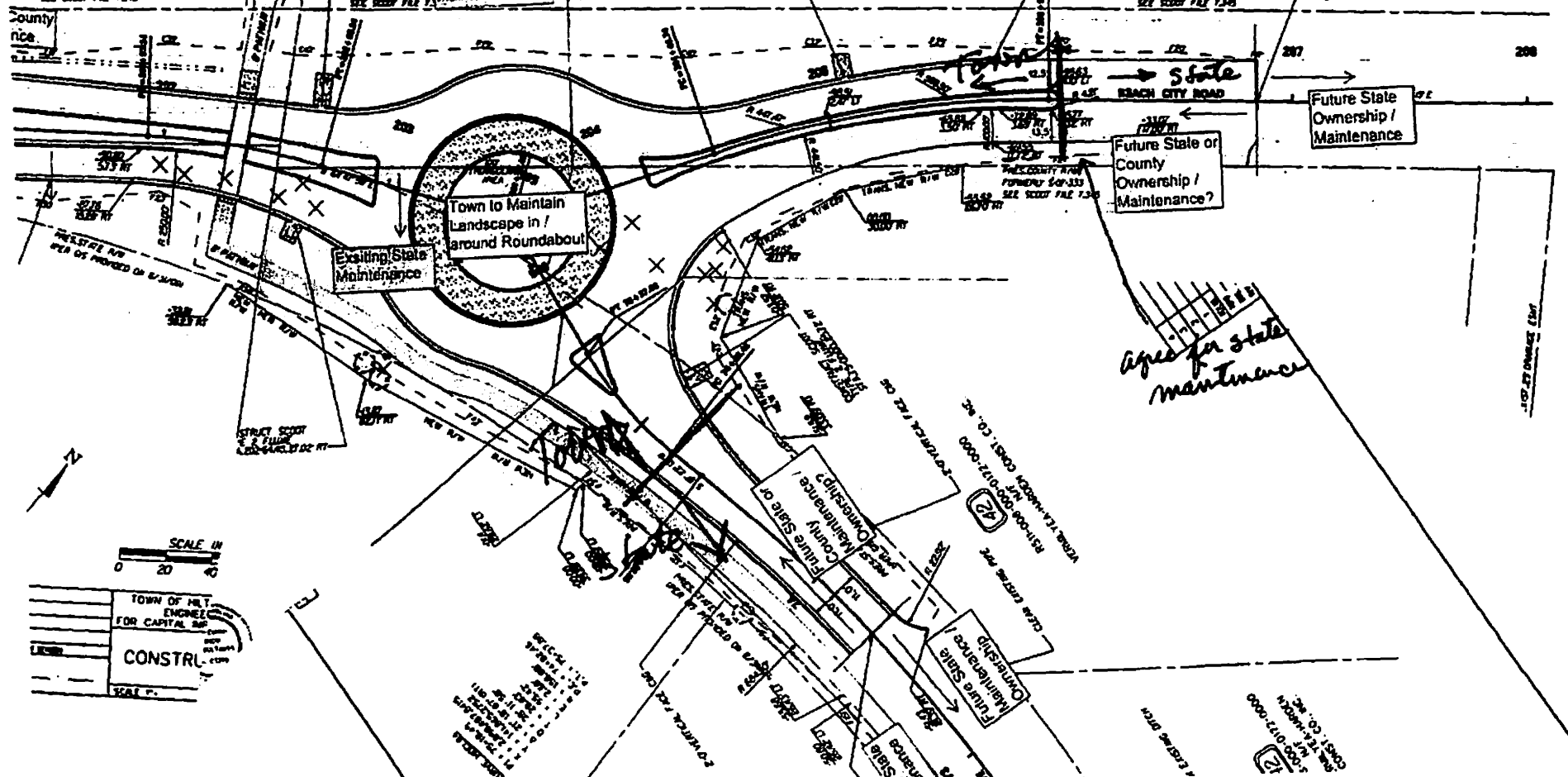

SCALE IN  
 0 20 40

TOWN OF PALMETTO  
 ENGINEER  
 FOR CAPITAL IMPROVEMENTS  
**CONSTRUCTION**

Mathews N / Beach City Road - SCDOT Proposed Ownership





**COUNTY COUNCIL OF BEAUFORT COUNTY  
BEAUFORT COUNTY ENGINEERING DIVISION  
102 Industrial Village Road, Building #3, 29906  
Post Office Drawer 1228, Beaufort, SC 29901-1228  
Telephone: 843-255-2700 Facsimile: 843-470-2630**

TO: Councilman Herbert Glaze, Chairman, Public Facilities Committee

VIA: Gary Kubic, County Administrator  
Bryan Hill, Assistant County Administrator  
Robert McFee, Director, Engineering and Infrastructure

FROM: Robert Klink, County Engineer

SUBJ: **Acceptance of Matthews Drive/Beach City Road Right-of-Way**

DATE: June 21, 2010

**Background.**

- 1) Matthews Drive and (a portion of) Beach City Road are SCDOT secondary highways on Hilton Head Island.
- 2) To improve traffic safety, the Town of Hilton Head plans to construct a roundabout at the intersection of Matthews Dr. and Beach City Rd.
- 3) Before SCDOT will issue a permit for the roundabout project, SCDOT is requiring the Town (or another government entity) assume ownership of a section of the SCDOT-owned Matthews Drive/Beach City Road right-of-way as shown on attached plat and construction plans.
- 4) The Town has requested that Beaufort County agree to accept ownership of, and maintenance responsibility for, both the SCDOT sections and the proposed roundabout.
- 5) The Town has agreed to install and maintain (by permit) the landscaping in and around the roundabout and to provide litter patrol in and around the roundabout.
- 6) The County will acquire ownership of the SCDOT right-of-way by submitting a "Request For Removal From State Highway System" form and by accepting a quit-claim deed for the same.

**Recommendations.** As the roundabout is expected to bring benefits in terms of traffic calming and safety, it is recommended that the Public Facilities Committee approve and recommend to County Council the acceptance of the SCDOT right-of-way for Beach City Road/Matthews Drive Roundabout.

REK/EMK/pae

Attachments: Location Map  
May 13, 2010 Letter From Town Of Hilton Head  
Right-Of-Way Plat  
Construction Plan Sheets (3)

cc: Eddie Bellamy  
z/PSC/10-03 matthews dr-beach city road row

# CURRENT BEACH CITY ROAD OWNERSHIP AND ALIGNMENT

APPROXIMATE LOCATION OF PROPOSED ROUNDABOUT

HH HOSPITAL

COUNTY PORTION OF BEACH CITY ROAD IN GREEN

STATE PORTION OF BEACH CITY ROAD

TOWN OF HILTON HEAD ISLAND

R510 008 000 0102 0000

BEACH CITY ROAD — S-T-333

MATHENS DRIVE — S-T-4A

WILLIAM HILTON PARKWAY — US 278

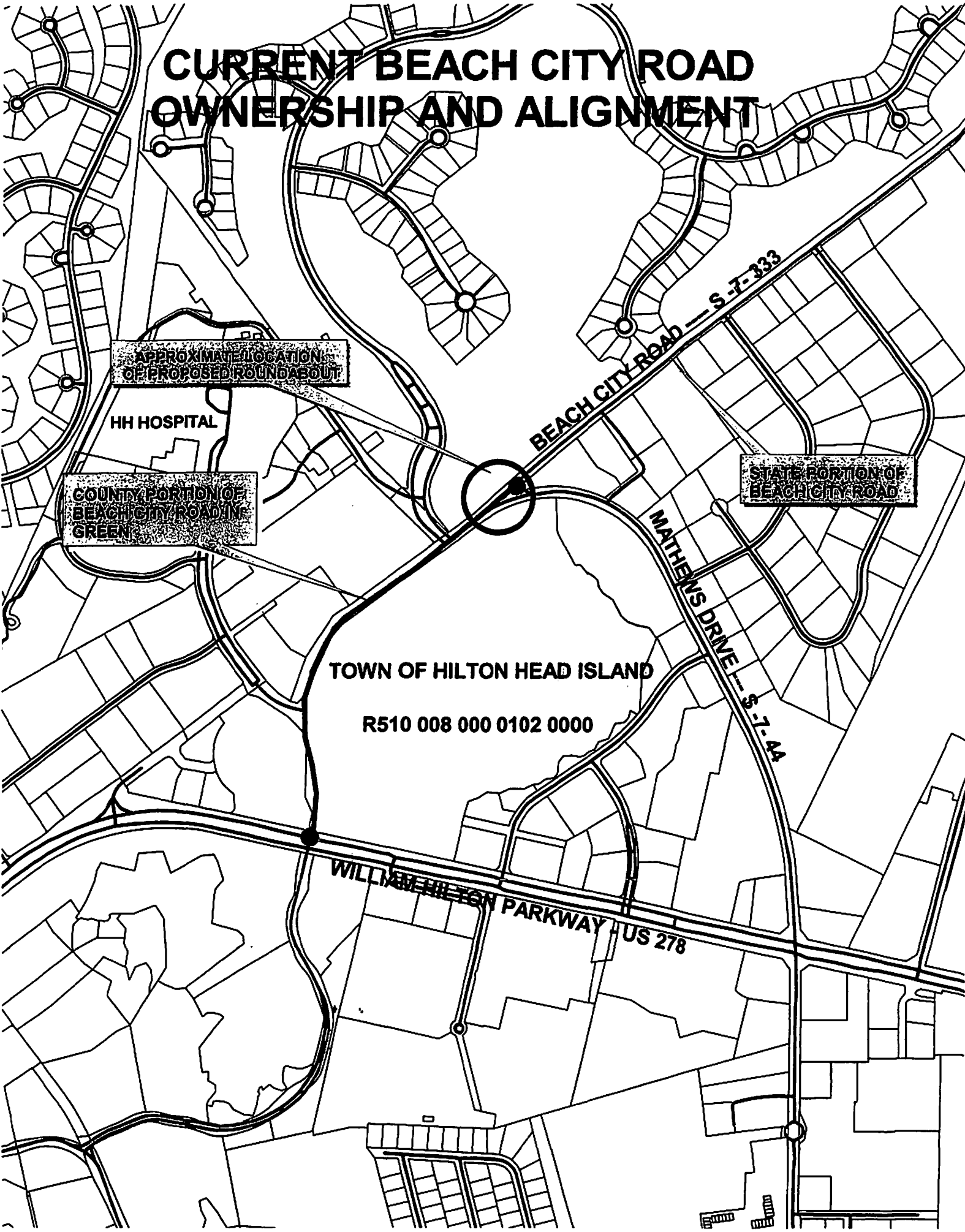

# TOWN OF HILTON HEAD ISLAND

One Town Center Court, Hilton Head Island, S.C. 29928

(843) 341-4600 Fax (843) 842-7728

www.hiltonheadislandsc.gov

May 13, 2010

Thomas D. Peoples  
Mayor

Kenneth S. Heitzke  
Mayor ProTem

\_\_\_\_\_  
Council Members

Willie (Bill) Ferguson  
William D. Harkins  
Drew A. Laughlin  
John Safay  
George W. Williams, Jr.

\_\_\_\_\_  
Stephen G. Riley  
Town Manager

Mr. Robert McFee, P.E.  
Director of Engineering & Infrastructure Division  
Beaufort County  
P.O. Drawer 1228  
Beaufort, SC 29901

Re: Mathews Drive (S-44) North Pathway and  
Roundabout Project at Beach City Road (S-333)

Dear Rob:

As we discussed last week, the Town has prepared construction plans associated with the above referenced project. As confirmed by County Staff, our investigation of right-of-way ownership indicates that the County owns that portion of Beach City Road from William Hilton Parkway (US 278-B) to Mathews Drive and the State owns the remaining portion of Beach City Road from Mathews Drive to Dillon Road. This line of demarcation between County and State ownership falls within the limits of our project and effectively severs ownership of the proposed roundabout. We seek to remedy this situation.

The final plans have been submitted to SCDOT for an encroachment permit approval. SCDOT has informed us that they will approve the encroachment permit conditioned that the Town or the County accepts ownership and maintenance responsibilities for the entirety of the proposed roundabout.

I am writing to request that the County accept the responsibilities associated with the ownership of the new roadway infrastructure. As you suggested, I respectfully request that the County encroachment permit be so conditioned.

The Town is fully prepared to install and maintain future landscaping and to provide litter patrol in the middle of and around the new roundabout. The attached plan sheets show the proposed, post project right-of-way limits and lines of ownership demarcation that the Town recommends.

Also attached is an updated encroachment permit application to correspond to the plans that were submitted to the County last week. The Town is preparing an easement plat for submittal to your office which shows the proposed County / State maintenance boundary lines. We will provide it upon completion, along with a signed and sealed set of plans.

Please do not hesitate to contact me at 843-341-4776 if you have any questions.

Best regards,

  
Scott Liggett, P.E.  
Director of Public Projects and Facilities

cc: Jeff Buckalew, Town of Hilton Head Island  
Wendell Mulligan, SCDOT Beaufort County Maintenance Office  
Kirk Richards, SCDOT District 6 Maintenance Office  
Billy Coleman, Coleman-Snow Associates

(without attachments)



COPY



RECEIVED

5/17/10 *SLG*

JUNE 09, 2010

Course	Bearing	Distance
C1	Rad: 780.40'	Arc: 187.88'
	Tan: 88.87'	CA: 18°08'52"
	Chd: N 72°47'40" W - 187.40'	
C2	Rad: 780.40'	Arc: 141.80'
	Tan: 71.18'	CA: 10°50'01"
	Chd: N 85°47'29" W - 141.80'	
C3	Rad: 780.40'	Arc: 121.78'
	Tan: 81.01'	CA: 9°17'43"
	Chd: N 84°18'28" E - 121.82'	
C4	Rad: 780.40'	Arc: 180.80'
	Tan: 80.07'	CA: 7°38'04"
	Chd: S 78°30'48" W - 88.83'	
C5	Rad: 10080.82'	Arc: 183.88'
	Tan: 81.88'	CA: 1°02'43"
	Chd: S 49°19'48" E - 183.88'	

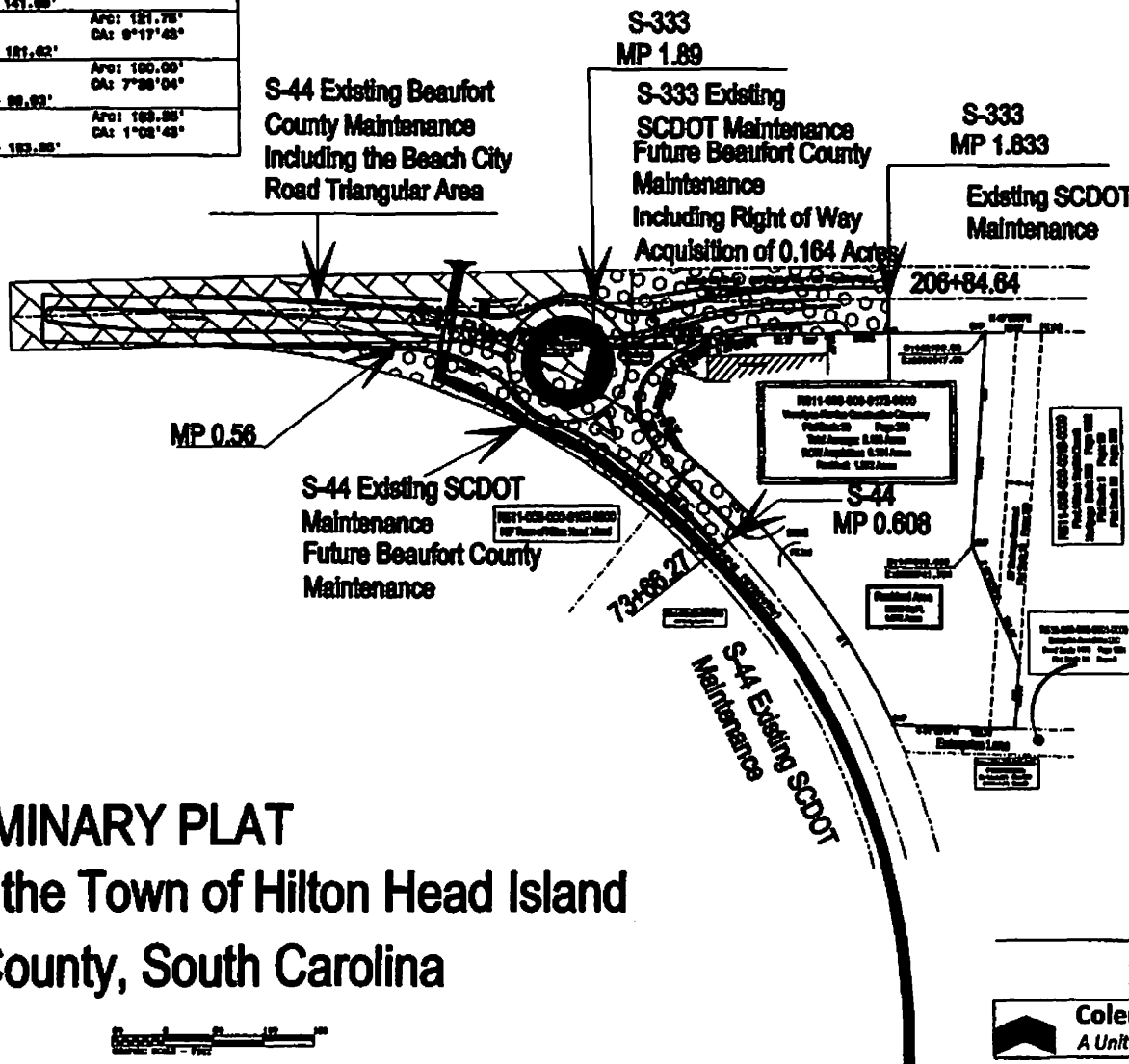

**Notes**

1. Not all improvements shown.
2. Encroachments or projections of trees, shrubs and vegetation are not shown.
3. No survey of subsurface features.
4. No land use agencies consulted.
5. A site search is not part of this survey.
6. This plat shows only easements which are obvious or apparent to the surveyor.
7. Wetland determinations have not been made for this property.

**Flood Statement**  
 Per FEMA FIRMS Community Panel 450250 0000 D dated September 28, 1986, this property appears to be located in Zone C.

**Legend**

- Property line with Owner Name (to be inserted)
- City
- County (to be inserted)
- Contract File
- Surveyed (to be inserted)
- Right of Way (to be inserted)
- Utilities
- Adjacent Property Line
- Existing Beaufort County Maintenance
- Utility (to be inserted)

**PRELIMINARY PLAT**  
 prepared for the Town of Hilton Head Island  
 Beaufort County, South Carolina



GARY J. STROBLE, PLS  
 1101 CLEMENTS FERRY RD.  
 CHARLESTON, SC 29402

**Coleman-Snow Consultants, LLC**  
 A United Infrastructure Group Company

NO.	DATE	BY	REV.	DESCRIPTION
3	11/11/10	WJ	1	ISSUED FOR CONSTRUCTION

**(44)**  
 R510-004-000-0304-0000  
 N/F  
 CNL INCOME PALMETTO LLC

**CURVE DATA**  
 P.I. = 282+31.77  
 X = 2,076,205.6253  
 Y = 141,641.8813  
 Δ = 13° 25' 05" (RT)  
 D = 17° 29' 42"  
 T = 38.52  
 L = 78.78  
 E = 2.25  
 R = 327.50'  
 •• MC  
 P.C. = 281+43.24  
 P.T. = 282+09.94

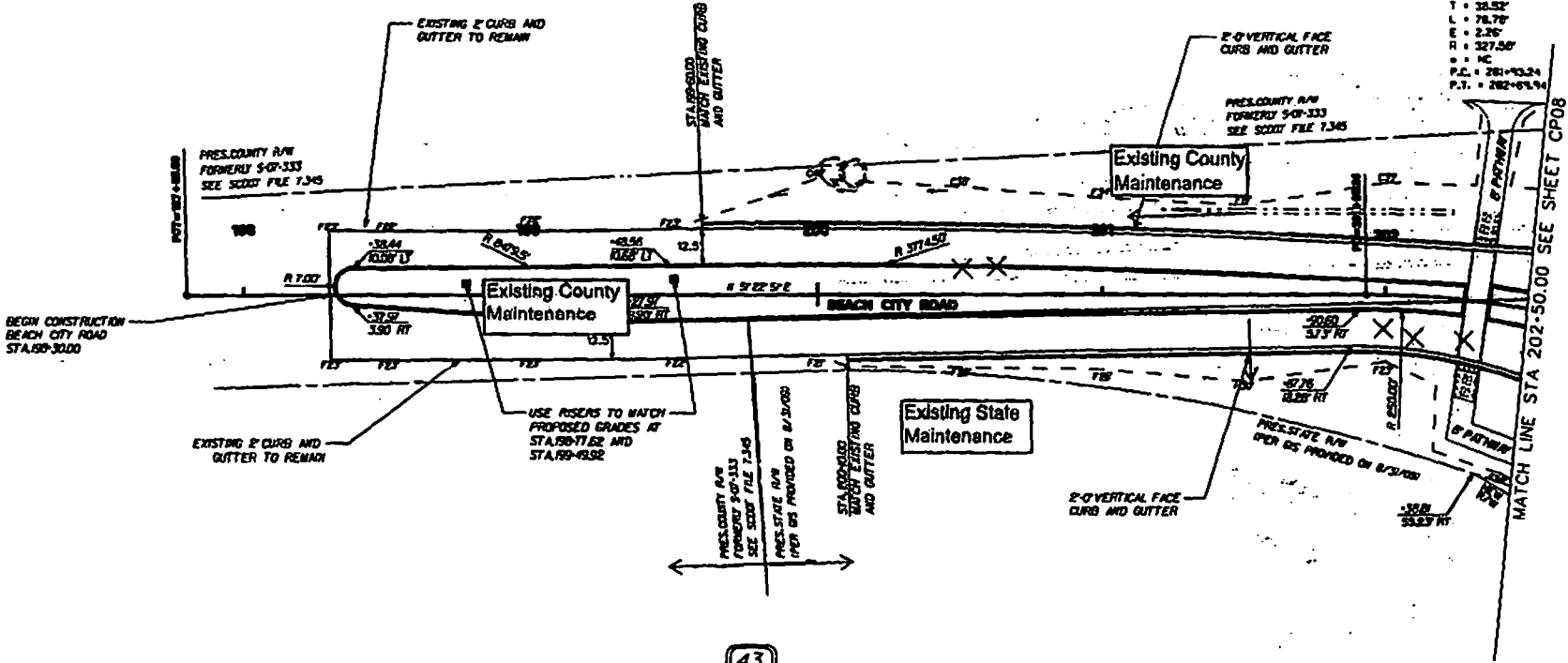

BEGIN CONSTRUCTION  
 BEACH CITY ROAD  
 STA. 50+00.00

MATCH LINE STA 202+50.00 SEE SHEET CP08

**(43)**  
 R510-008-000-0102-0000  
 N/F  
 TOWN OF HILTON HEAD ISLAND

TREES TO BE REMOVED AND TRANSFERRED							
TREE TYPE	FULL NAME	CATEGORY	SIZE	STATION	ROAD NAME	OFFSET	PATH OR ROAD
PLM	PALM	N	10"	800+51.0	BEACH CITY	17.44 LT	ROAD
PLM	PALM	N	10"	800+63.19	BEACH CITY	17.84 LT	ROAD
PLM	PALM	N	8"	801+59.32	BEACH CITY	5.03 RT	ROAD
PLM	PALM	N	8"	802+42.44	BEACH CITY	7.72 RT	ROAD



- NEW R/W
- RETAIN TREE
- REMOVE TREE
- TREE PROTECTION FENCE

4				
3				
2				
1				
TOWN OF HILTON HEAD ISLAND, SC ENGINEERING SERVICES FOR CAPITAL IMPROVEMENTS PROJECTS				
<b>CONSTRUCTION PLANS</b>				
DATE	BY	CHK	GROUP	SCALE



REV.	DATE	BY	CHK.	APP.
3	E.C.	REAPPORT		

**CURVE 1002.83**  
 P1 = 71+15.97  
 X = 2,078,897.5878  
 Y = 141,887.7723  
 Δ = 84°18' 32" 0.71  
 D = 8784' 11"  
 T = 446.37  
 L = 796.91  
 C = 128.67  
 R = 718.80  
 P.C. = 68+69.63  
 P.T. = 74+66.23

**(38)**  
 RS10-008-000-0250-0000  
 N/F  
 TABBY ASSOCIATES

**CURVE 1002.81**  
 P1 = 75+18.49  
 X = 2,098,487.8413  
 Y = 141,883.2732  
 Δ = 21° 18' 07" 071  
 D = 30' 11" 50"  
 T = 28.87  
 L = 95.42  
 E = 2.68  
 R = 158.80  
 P.C. = 74+02.46  
 P.T. = 75+37.23

MATCH LINE STA 70+30.00 SEE SHEET CPO5

MATCH LINE STA 75+30.00 SEE SHEET CPO8



BEING CONSTRUCTION  
 MARKERS (DOVE)  
 STA 72+66.23

Existing State  
 Maintenance

Future State  
 Maintenance /  
 Ownership

Future County  
 Maintenance /  
 Ownership

**(42)**  
 RS11-008-000-0172-0000  
 N/F  
 VERMILYEA-HARDEN CONST. CO., INC.

**(42)**  
 RS11-008-000-0172-0000  
 N/F  
 VERMILYEA-HARDEN  
 CONST. CO., INC.

- REQUIRED R/W
- RETAIN TREE
  - REMOVE TREE
  - TREE PROTECTION FENCE



4			
3			
2			
1			
REV.	BY	CHK.	DESCRIPTION OF REVISION
100	MCJ		
00	MCJ		GROUP
00	MCJ		

TOWN OF HELTON HEAD ISLAND, SC  
 ENGINEERING SERVICES  
 FOR CAPITAL IMPROVEMENTS PROJECTS

**CONSTRUCTION PLANS**

SCALE: 1" = 40'

COPY

DATE	BY	REVISION	FILE NO.	DATE	BY
3	S.E.	BEARPORT	E-333	CP08	

**CURVE DATA**  
 P.L. = 588+88.08  
 X = 2,078,361.487+  
 Y = 141,888,8263  
 Δ = 329° 04' 20" (L.T.)  
 D = 127° 14' 20"  
 T = 8.88'  
 L = 292.74'  
 E = 98.88'  
 R = 45.88'  
 • = MC  
 P.C. = 588+88.08  
 P.T. = 582+82.74

**CURVE DATA**  
 P.L. = 285+22.41  
 X = 2,078,422.4767  
 Y = 142,833.4118  
 Δ = 12° 48' 02" (R.T.)  
 D = 12° 52' 32"  
 T = 73.87'  
 L = 148.82'  
 E = 6.86'  
 R = 418.88'  
 • = MC  
 P.C. = 284+48.74  
 P.T. = 285+94.78

**44**  
 RS10-004-000-0304-0000  
 N/F  
 CAR. INCOME PALMETTO LLC

**42**  
 RS11-008-000-0172-0000  
 N/F  
 VERMILYEA-HARDEN CONST. CO., INC.

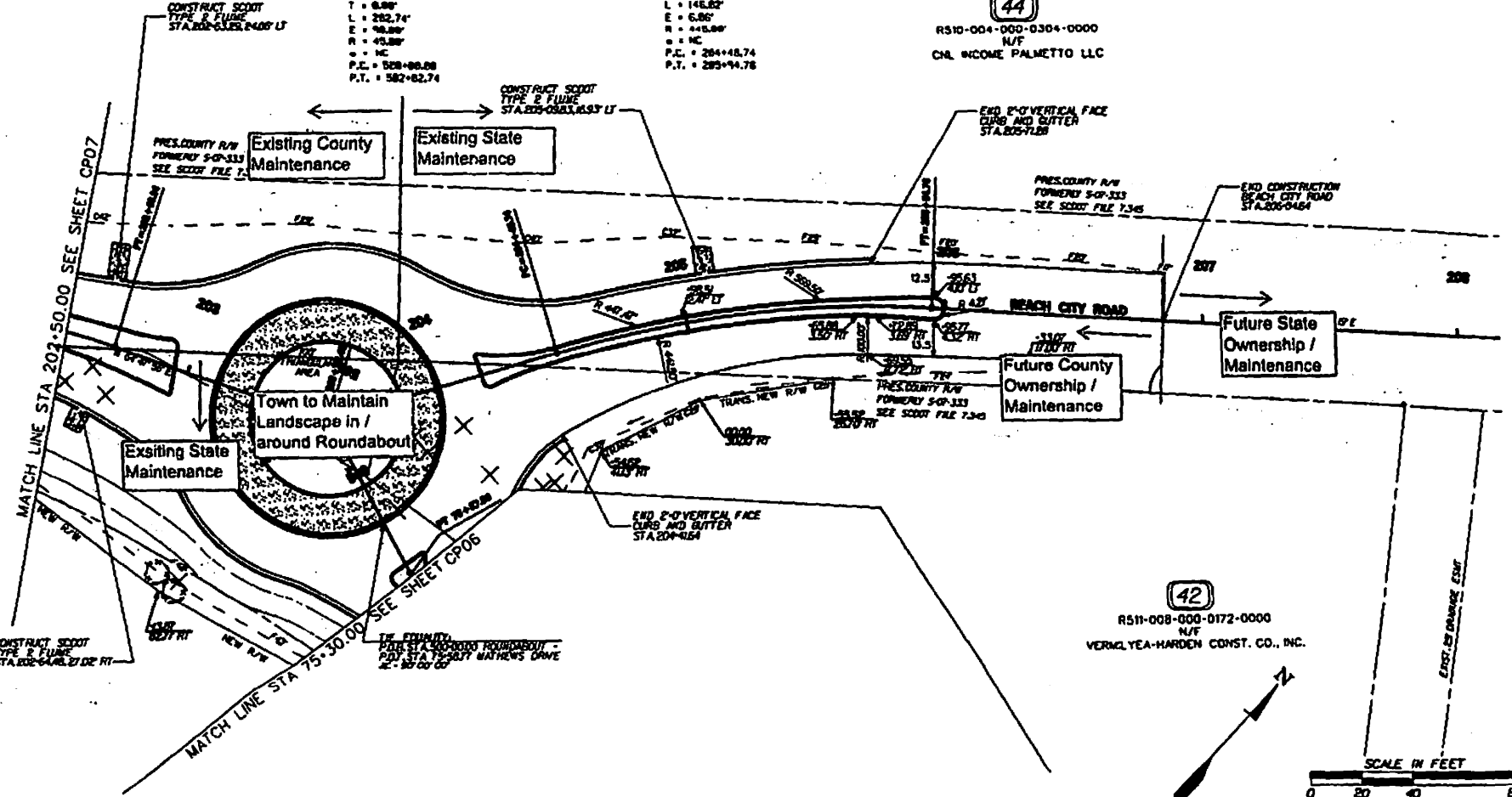

COPY



- REQUIRED R/W
- RETAIN TREE
- ✕ REMOVE TREE
- TREE PROTECTION FENCE

TREES TO BE REMOVED AND TRANSFERRED							
TREE TYPE	FULL NAME	CATEGORY	SIZE	SYSTEM	ROAD NAME	OFFSET	POST-REMOVAL
FLR	FLR	N	8"	SP-6	BEACH CITY	7 FT	ROAD
FLR	FLR	N	8"	SP-6	BEACH CITY	488 LT	ROAD
FLR	FLR	N	8"	SP-6	BEACH CITY	488 RT	ROAD
FLR	FLR	N	8"	SP-6	BEACH CITY	1588 RT	ROAD

4				
3				
2				
1				
0				
DATE	BY	CHKD	EXCHG'D BY	
DATE	BY	DATE	GROUP	
DATE	BY	DATE		

TOWN OF HILTON HEAD ISLAND, SC  
 ENGINEERING SERVICES  
 FOR CAPITAL IMPROVEMENTS PROJECTS

**CONSTRUCTION PLANS**

SCALE: 1" = 40'